



  
**EDAN**  
**X Series**  
(X 8/10/12)

## Quick Setup Guide

Patient Monitors with  
Capnography

# WELCOME

Your monitor has been configured according to the instructions in this guide. Retain this guide as a reference should any changes or adjustments be necessary.

This guide does not replace the full user manual but complements it, providing a resource for quick reference in clinical settings.

**For additional support needs, please use the QR code provided to access resources and assistance.**



**SCAN FOR  
SUPPORT**

# CONTENTS

Hard Menu Button .....	1
Parameter Setup.....	1
Display Setup.....	1
Shortcut Menu Customization .....	2
Alarm Setup.....	2
Date and Time.....	2
Start a New Patient.....	3
Standby Mode.....	3
Save Your Settings.....	3
Test Your Settings/Demo Mode.....	4
Record (Printer) Setup.....	4
Print Out Each Time BP is Taken.....	4
Print Out at the End.....	5
Troubleshooting.....	5
ECG Waveform.....	5
Memory.....	6
Data Store Setup.....	6
Review or Print .....	6
G2 Capnography Guide.....	7
Zero Calibration.....	7
Accessories.....	8
Disposable Supplies .....	9
Mounting Options.....	9

# HARD MENU BUTTONS



- **Mute:** Silence current audible alarm for 120 seconds
- **NIBP:** Starts and stops a blood pressure
- **Trend Table:** View/Print the history of a patient
- **Freeze:** Print concise ECG waveform or scroll back to review waveforms on the screen
- **Record:** Print waveform with long header
- **Menu:** Access Menu

# PARAMETER SETUP

- Touch or press MENU
- Touch SYSTEM SETUP
- Touch MODULE SWITCH

ECG     NIBP     SpO<sub>2</sub>  
            CO<sub>2</sub>     PR

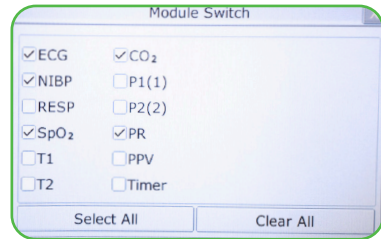

# DISPLAY SETUP

- Press MENU – Touch DISPLAY SETUP
- View Selection – “Standard”
- Wave. Num. – “4” (If additional parameters are added, this will need to be adjusted.)
- Control Bar – “On” (Optional “On Screen” Shortcuts)

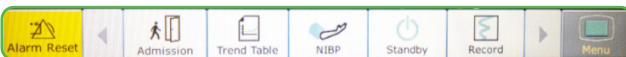
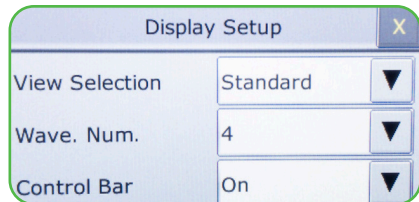

# SHORTCUT MENU CUSTOMIZATION

- Press MENU
- Touch MAINTENANCE
- Touch USER MAINTAIN

COMMON SELECTIONS:  
Admission – Trend Table –  
NIBP – Standby – Record

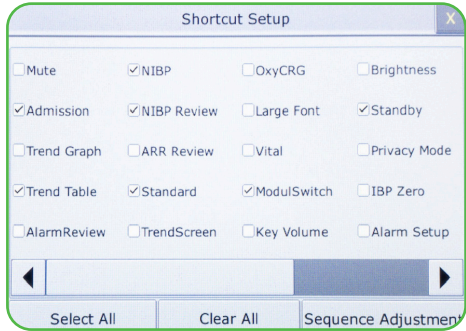

# ALARM SETUP

- Touch any parameter square on the right side
- Touch ALARM SETUP
- Set high and low alarms for each parameter

**NOTE:** CO<sub>2</sub> and NIBP have drop down menus for additional alarm settings.

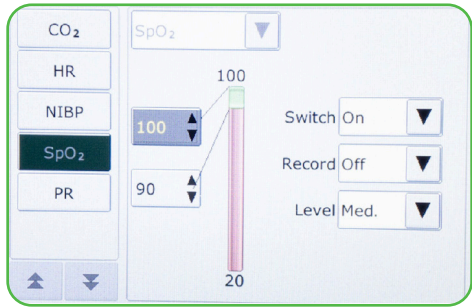

“Switch” should be ON for EACH parameter alarm

“Record” should be OFF for EACH parameter alarm

(Apnea Alarm – See CO<sub>2</sub> Setup Menu)

# DATE AND TIME

- Press or touch MENU
- Touch COMMON FUNCTION
- Touch DATE AND TIME SETUP
- Set date and time accordingly

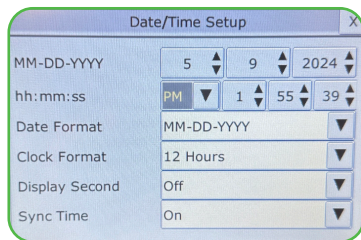

## START A NEW PATIENT

- **OPTION I:** Select **ADMISSION** from the Shortcut Menu
- **OPTION II:** Quick Admit - Option to enter patient info later  
**MENU — PATIENT SETUP — QUICK ADMIT**
- **OPTION III:** Admit and enter patient info  
**MENU — PATIENT SETUP — NEW PATIENT**

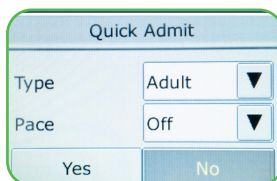
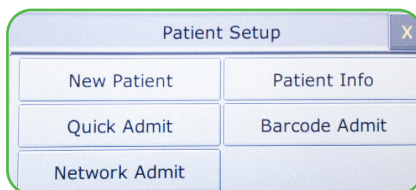

## STANDBY MODE

Interrupts monitoring without losing the current data

**OPTION I:** MENU — COMMON FUNCTION — STANDBY

**OPTION II:** Choose STANDBY from the Shortcut Menu

**NOTE:** Choosing “Yes” to change to Standby Mode WILL NOT affect patient data.

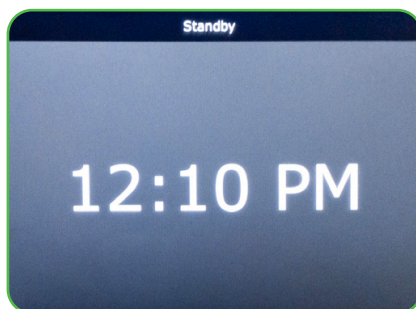

## SAVE YOUR SETTINGS

- Touch or press MENU
- Touch MAINTENANCE
- Touch USER MAINTAIN
- Enter Password “ABC” “OK”
- Touch USER PROFILE — SAVE
- Enter a name for the profile (i.e., SEDATION, OCS, etc.) “OK”/Profile

**The file has been saved!**

To continue:

1. Close the window by tapping the X in the corner.
2. The saved profile will appear on the screen. Tap the X again to close it.

To overwrite a profile:

1. Select the profile to overwrite. Touch SAVE.
2. Enter the exact profile name using the keyboard, then “OK”.
3. Confirm by selecting YES to overwrite.

# TEST YOUR SETTINGS/DEMO MODE

- Touch or Press MENU
- Touch COMMON FUNCTION
- Touch DEMO MODE
- Enter Password “3045” “OK” (Turn off the monitor to exit Demo Mode)

# RECORDER (PRINTER)

- Touch or Press MENU
- Touch SYSTEM SETUP
- Touch RECORDER SETUP

**IMPORTANT:** Record Interval must be Off. If it is not set to off, waveforms will print continually.

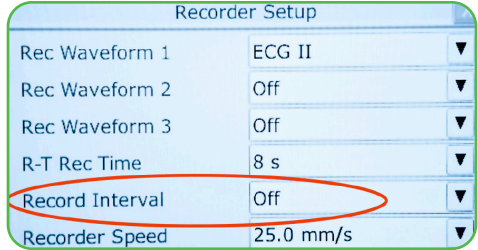

Place paper roll in printer compartment as shown. Do not feed through rollers.

**NOTE:** Grid paper loads opposite.

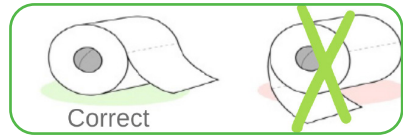

# PRINTOUT EACH TIME BP IS TAKEN

Turn on NIBP Trigger Recording

- Touch or Press MENU
- Touch MAINTENANCE
- Touch USER MAINTAIN
- Password “ABC” OR “123” - “OK”
- Touch OTHER SETUPS
- NIBP Trigger Recording – “ON” (see example blow)

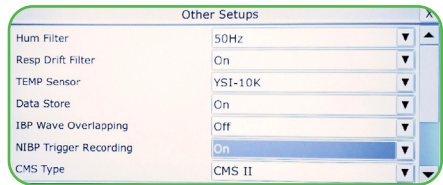

10-10	10-10	10-10	10-10
HR (bpm) 03:12:41	HR (bpm) 50	HR (bpm) 08:12:47	HR (bpm) 60
SpO <sub>2</sub> (%) 99	SpO <sub>2</sub> (%) 99	SpO <sub>2</sub> (%) 99	SpO <sub>2</sub> (%) 99
NIBP (mmHg) 124/73 (91)	NIBP (mmHg) 119/77 (88)	NIBP (mmHg) 120/70 (83)	NIBP (mmHg) 116/70 (86)
PR (NIBP) (bpm) 69	PR (NIBP) (bpm) 64	PR (NIBP) (bpm) 66	PR (NIBP) (bpm) 65
PRC <sub>2</sub> (/min) 6	PRC <sub>2</sub> (/min) 6	PRC <sub>2</sub> (/min) 6	PRC <sub>2</sub> (/min) 6
PR (bpm) 60	PR (bpm) 60	PR (bpm) 60	PR (bpm) 60
EtCO <sub>2</sub> (mmHg) 39	EtCO <sub>2</sub> (mmHg) 38	EtCO <sub>2</sub> (mmHg) 38	EtCO <sub>2</sub> (mmHg) 38
PiCO <sub>2</sub> (mmHg) 1	PiCO <sub>2</sub> (mmHg) 1	PiCO <sub>2</sub> (mmHg) 1	PiCO <sub>2</sub> (mmHg) 1
AWRR (rpm) 14	AWRR (rpm) 14	AWRR (rpm) 14	AWRR (rpm) 14

Example - Not Actual Size — 20 min @ 5 Min Intervals



# PRINT OUT AT THE END

- Touch TREND TABLE
- Touch the down arrow next to Interval reading — scroll to the bottom — select “NIBP”
- Touch RECORD ALL
- Touch RECORD ALL again (see example below)

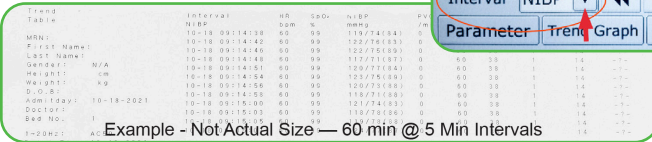
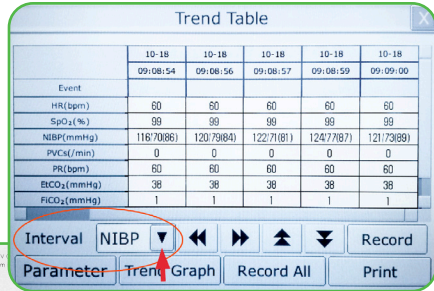

# TROUBLESHOOTING

If monitor is printing out continuously:

- Check Recorder Setup as shown above
- Make sure that RECORD is set to “OFF” on EACH alarm in Alarm Setup

# ECG WAVEFORM

- **Option I:**
  - Press the FREEZE button
  - Touch TIME Box and scroll to desired time
  - Touch RECORD
- **Option II:** Touch the Short Cut RECORD — waveform will print according to the settings in Recorder Setup {8s, 20s, Continual}

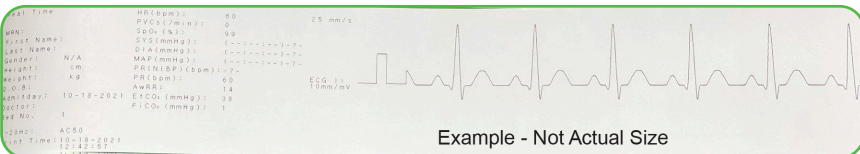
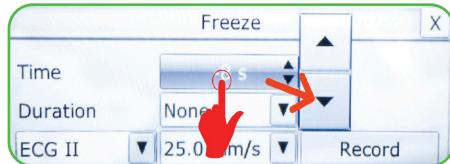

## MEMORY

Internal Memory allows review of data on the monitor after it has been turned off or a patient has been dismissed.

### DATA STORE SETUP

- Press MENU
- Touch COMMON FUNCTION
- Touch DATA STORE
- Storage Device – INTERNAL STORAGE DEVICE

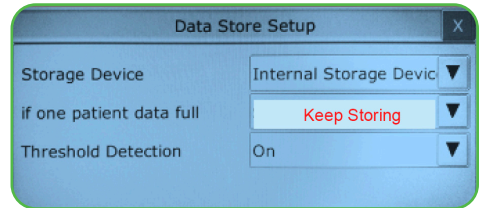

If the patient data is full — “Keep Storing” will allow data from older cases to be overwritten and the monitor to continue storing.

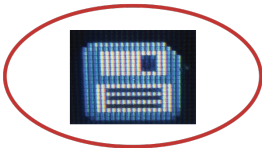

**IMPORTANT:** Data is not being stored unless the storage icon is being displayed.

## REVIEW OR PRINT

Follow these steps to review/print data from memory:

- Press MENU
- Touch REVIEW
- Touch HISTORY PATIENT
- Choose your Storage Device
- Choose the name of the patient or the date/time of the case
- Touch TREND TABLE
- To print, follow steps on page 5 for “Print Out At the End”



# G2 CAPNOGRAPHY GUIDE

## ZERO CALIBRATION

In order to obtain consistent readings and to extend the life of the CO<sub>2</sub> module, Zero Calibration is recommended each time CO<sub>2</sub> is used.

1. Sampling line or cannula should be connected
2. Keep the CO<sub>2</sub> line away from sources of CO<sub>2</sub>, including the patient's breath, the operator's breath, and the ventilator (if applicable).
3. Touch the ETCO<sub>2</sub> parameter tile on the monitor. Once in the CO<sub>2</sub> SETUP menu, set the Work Mode to MEASURE.
4. Touch ZERO CALIBRATION



- The system briefly displays “Zeroing In Progress”. This may take 3 to 15 seconds.
- After the zero calibration is finished, CO<sub>2</sub> monitoring can be resumed.
- If the system displays “Breath Detected” or “Zero Required”, zeroing has failed. Zero calibration must be performed again.

## IMPORTANT:

- Set Work Mode to STANDBY when CO<sub>2</sub> is not being used.
- If CO<sub>2</sub> is not reading, check that Work Mode is set to MEASURE.

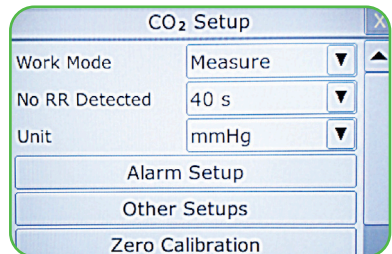

**NOTE:** Do not cover or block the sampling line or cannula. This will cause an occlusion and potentially cause your internal CO<sub>2</sub> component to fail.

# ACCESSORIES

## Extension Cable

- 7-1068-6 Extension Cable (7-Pin to DB9), 6 ft



## Blood Pressure Cuffs

- 7-40204 E6 Small Child
- 7-40212 E7 Child
- 7-40211 E8 Small Adult
- 7-40205 E9 Adult
- 7-40210 E10 Large Adult
- 7-40213 E11 Thigh



## Short Sensors (Must have DB9 Extension Cable)

- 7-2120-3 Clip, 3 ft
- 7-2123-3 Wrap, 3 ft
- 7-2122-3 Silicone Soft-tip Adult, 3 ft
- 7-2121-3 Silicone Soft-tip Child, 3 ft
- 7-2121-4 Silicone Soft-tip Small Child, 3 ft
- 7-2250-0 Ear Clip Adult/Pediatric, 3 ft



## Multi Site Disposables

- 7-S803 Multi Site with 25 disposable wraps (DB9), 3 ft (Requires Extension Cable 7-1058-6)

## Standard Components

- 7-5029-8 SpO<sub>2</sub> Reusable Clip Sensor, 8 ft (7-Pin)
- 7-36119 NIBP Hose for Reusable Cuffs, 10 ft
- 7-4712 3-Lead, 12-Pin ECG Cable-Snap Leadwires
- 7-4380 Rechargeable Lithium-Ion Battery



## DISPOSABLE SUPPLIES

- 7-200-60 Kendall™ ECG Electrodes (60/pk)
- 7-200-40 Dentrede® ECG Electrodes (30/pk)
- 7-202-50G Paper with Grid (12/bx)
- 7-202-50 Paper Solid White (12/bx)
- 7-4510 Sampling Line Male/Male (25/bx)
- 7-4000 Sampling Cannula Male (25/bx)
- 7-4707 Divided Cannula Male (25/bx)
- 7-3810 Water Trap

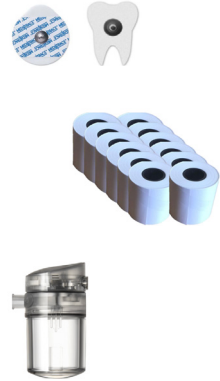

## MOUNTING OPTIONS

### Roll Stand with Basket & Mounting Plate

- 7-207-1 Fits M3, iM3, iM50, X8, X10
- 7-207-2 Fits iM60, iM70, X12

### Wall Mount with Basket (Includes Mounting Plate)

- 7-IM50-MT Fits M3, iM3, iM50, X8, X10
- 7-IM60-MT Fits iM60, iM70, X12

### Rolling Carry Case

- 7-5013 Universal Carry Case



SEDATIONRESOURCE.COM

MONITOR  
SUPPORT  
VIDEOS



YOUR PARTNER IN PATIENT SAFETY