

ANNUAL CATALOG
2025

SR Sedation
Resource

EDAN



ZOLL



 **SEDATION
STETHOSCOPE**
Amplified PreTracheal | 



SEDATION**RESOURCE**.COM

YOUR **PARTNER** IN
PATIENT **SAFETY**

03 MONITORING

- 04. Patient Monitors
- 05. Patient Monitors
- 06. Vital Signs
- 07. EDAN SPO₂ Sensors
- 08. EDAN Accessories
- 09. Mounting Options
- 10. CO₂ Supplies
- 11. Miscellaneous

12 OXYGEN/AIRWAY

- 13. Basic Airway
- 14. O₂ Connections
- 15. Oxygen and CPR Supplies

16 ADVANCED AIRWAY

- 17. Airways
- 18. Airways
- 19. Endotracheal Tubes
- 20. ET Tubes - Laryngeal Masks
- 21. Laryngoscopes
- 22. Airway Management Kits
- 23. Cricothyrotomy Kit and Adapters

24

- 25. Amplified PreTracheal
- 26. Accessories
- 27. Features and Support

28 IV ADMINISTRATION

- 29. Extension Sets
- 30. IV Equipment
- 31. Needles & Syringes
- 32. IV Catheters
- 33. IV Tourniquets & Supplies

34 MISCELLANEOUS

- 35. Syringe Labels
- 36. Miscellaneous Supplies
- 37. Airway Positioners

38 ANESTHESIA

- 39. Anesthesia Supplies

40 NITROUS OXIDE

- 41. Nitrous Oxide
- 42. Nitrous Oxide

44 SUCTION & BACK-UP

- 45. Suction
- 46. Diagnostic Back-up

48 EMERGENCY

- 49. ZOLL AEDs
- 50. AEDs and Supplies
- 51. Intraosseous
- 52. Simulation Tools

53 WHAT'S NEW**YOUR PARTNER IN PATIENT SAFETY**

For over 20 years, we've specialized in providing tailored sedation and emergency solutions.

Our mission is simple: reliable products, competitive pricing, and expert support to help your practice succeed.

OUR COMMITMENT TO YOU:

We're dedicated to providing dependable service, essential products, and solutions to support your practice.

Your success is our priority.



We're proud to celebrate 20 years of supporting the sedation community and look forward to our continued partnership with you.

ONLINE ORDERING**Call or Click—Your Choice!**

- View our current prices online
- Order anytime with 24/7 access
- Prefer personalized service? We're just a phone call away!

Visit us at SedationResource.com to get started!

WE KNOW MONITORS



Edan Patient Monitors are designed for dental professionals across all specialties, providing vital signs measurements such as ECG, SpO₂, blood pressure, heart rate, and capnography. Capnography plays a critical role in monitoring respiratory function during sedation, enhancing patient safety. With a user-friendly interface and high accuracy, these monitors deliver reliable performance and peace of mind for both practitioners and patients.



CONFIDENCE THROUGH MONITORING

Bring confidence to your practice with monitors designed for reliable, seamless operation—offering all the essential features you need for patient care and peace of mind:



Capnography

Respiratory function is monitored through capnography, helping to detect early signs of breathing issues under sedation and enhancing patient safety throughout procedures.

Customized

Our preprogrammed monitors let doctors plug in and start monitoring instantly.



All-Inclusive Features:

- ECG, NIBP, SpO₂, Heart Rate, Respiration
- ST and ARR Arrhythmia Analysis
- Capnography
- Touch Screen Display
- On-screen Shortcuts
- External Display via VGA
- Integrated Printer
- Battery for portability
- Direct Customer Support

Exclusive 3-Year Warranty



EDAN



Exclusive 3-Year Warranty



7-IM70GT
12.1" Display

7-IM60GT
10.4" Display

*Agent ID model available



Included Accessories:

- ✓ 3-Lead ECG Cable
- ✓ Blood Pressure Cuffs (3)
- ✓ NIBP Hose
- ✓ SpO₂ Sensor
- ✓ Skin Temp Probe
- ✓ Battery
- ✓ CO₂ Water Trap
- ✓ Thermal Paper
- ✓ CO₂ Sample Pack



7-X12
12.1" Display

7-X10
10.1" Display

7-X8
8" Display

7-M3P Vital Signs Monitor

SpO₂—Pulse Rate—Blood Pressure

- High Resolution Display
- Audible & Visual Alarms
- Internal Battery
- Built-in Printer
- Three BP Cuffs
- SpO₂ Sensor (Lemo)
- 2-Year Warranty



7-M3P

7-iM3 Vital Signs Monitor

SpO₂—Pulse Rate—Blood Pressure

- Lightweight, Slimline Design
- Touch Screen
- High Resolution Display
- Audible & Visual Alarms
- Updated Printer
- Paper saving horizontal printout
- Internal Battery
- Three BP Cuffs
- SpO₂ Sensor (DB9)
- 2-Year Warranty



7-iM3

7-M3B-C Capnography Monitor

ETCO₂— Respiration Rate

- Respiration LoFlo Side-Stream EtCO₂
- Airway Respiration Rate
- Audible & Visual Alarms
- Respiration
- Battery
- Printer
- 2-Year Warranty



7-M3B

7-H100B Handheld Pulse Oximeter

Heart Rate— SpO₂

- Audible & Visual Alarms
- Includes 3 ft clip SpO₂ Sensor
- Carrying Case
- 2-Year Warranty





EDAN

iM3 — X Series

- 7-5029-8 Clip Sensor (7 Pin) 8 ft
- 7-1068-6 Extension Cable (7 Pin to DB9) 6 ft



M3 — IM Series

- 7-2119-8 Clip Sensor (Lemo) 8 ft
- 7-2101-6 Extension Cable (Lemo to DB9) 6 ft
- 7-2101-12 Extension Cable (Lemo to DB9) 12 ft



7-D2D Additional Length Cable (DB9 to DB9) 5 ft
(Requires an extension cable)



Short Sensors — 3 ft Must have DB9 Extension Cable

- 7-2120-3 Clip
- 7-2123-3 Wrap
- 7-2250-0 Ear
- 7-2122-3 Soft-tip Adult
- 7-2121-3 Soft-tip Child
- 7-2121-4 Soft-tip Small Child



Multi-site Sensor 3 ft

- 7-2124-3
- Includes: Foam Wrap
- (5) Adult Adhesives
- (5) Child Adhesives



Disposable Sensor 1.5 ft

- 7-2197-1 Pediatric
- 7-2196-1 Adult



Blood Pressure Cuffs

- 7-40204 E6 Sm Infant (13-17 cm)
- 7-40212 E7 Infant (14-21.5 cm)
- 7-40211 E8 Sm Adult/Child (20.5-28 cm)
- 7-40205 E9 Adult (27-35 cm)
- 7-40210 E10 Large Adult (34-43 cm)



7-40213 E11 Thigh (42-54 cm)



7-36118 IM Series Hose
7-36119 X Series Hose

ECG Cables

3-LEAD

- 7-4711 IM Series Snap 3-Lead
- 7-4712 X Series Snap 3-Lead



5-LEAD

- 7-4710 IM Series Snap 5-Lead
- 7-4713 X Series Snap 5-Lead



CO₂ Water Trap



7-3810
Use with X Series and IM Series

Lo Flo CO₂ Dehumidification Tubing



7-8154
Fits Units with Lo Flo External Module

Edan Compatible Printer Paper

- 7-202-50 12/bx No Grid
- 7-202-50G 12/bx Grid

Edan OEM Printer Paper

- 7-780-35 4/bx

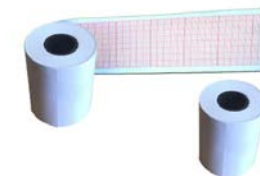

Replacement Batteries

- 7-4380 X Series
- 7-4142 IM Series
- 7-4365 iM3 Vitals
- 7-4167 M3 Vitals





**EDAN Roll Stands
Includes Plate**

- 7-207-1 M3, iM3, iM50, X8, X10
- 7-207-2 iM60, iM70, X12
- 7-LB Lower Basket (Optional)

Carrying Case

Compatible with Edan iM and X Series.

Dimensions:
14 x 12.5 x 10.5
7-5013



**Wall Mount
(Requires Plate)**
7-WallMount



7-Plate-1
Mounting Plate for M3,
iM50, iM3, X8, X10

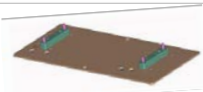

7-Plate-2
Mounting Plate for
iM60, iM70, X12



CMS Lite III Data Management Software

- Paperless documentation of Vital Signs Trend Table
- Simple off-line data transfer from USB
- USB importing is compatible with Edan iM60, iM70 (v1.2), X Series, and iM3
- Compatible with all EMRs

7-CMSLite-3

See website for recommended computer components



Sampling Lines

7-4510
10' Male/Male 25/bx

7-4515
15' Male/Male 25/bx



Sampling Cannula

7-4000
7' Male Luer 25/bx



Divided Sampling Cannula

7-4707
7' O₂ — 7' CO₂
Male Luer 25/bx

7-4707-10
10' O₂ — 10' CO₂
Male Luer 25/bx



Additional Options Available - See Website for Details

Sampling Options with Female Luer 25/bx

- 7-4410 10' Male/Female Sampling Line
- 7-4707F 7' O₂ & 7' CO₂ Divided Sampling Cannula Female Luer
- 7-4706F 7' O₂ & 2" CO₂ Divided Sampling Cannula with 2" CO₂ Pigtail Female Luer
- 7-4000F 7' Nasal Sampling Cannula Female Luer

CO₂ Nitrous Hood Adapters

4-53055
Single Lumen 24/pk

4-43055
Double Lumen 12/pk

4-5054-25 Plastic 25/pk
4-5054-3 Metal (each)

Water Traps

- 7-600-03 Nonin Water Trap w/ Filters 10/pk
- 7-600-07 Nonin Filters 25/pk



- 7-10530 Mindray Dryline
- 7-10530F Mindray Dryline II (Flat Top)

Kendall ECG Electrodes
by Cardinal Health

- 7-200-60 Round Shape
20 pks of 3 electrodes/pk
- 7-200-30 Mini Round Shape 30/pk



DeTrode™ Made in USA

High Performance ECG Electrodes

- 7-200-40 Tooth Shape 30/pk
- 7-200-50 Round Shape 30/pk



Blood Pressure Cuffs

- 7-000-1 Child 10-19 cm Orange
- 7-000-2 Small Adult 18-26 cm Lt Blue
- 7-000-3 Adult 25cm-35 cm Dk Blue
- 7-000-4 Large Adult 33-47 cm Red

- 7-202-30 Mindray Thermal Paper 12/bx



Compatible SPO₂ Sensors

- 7-000-16 Masimo Ext Cable 7 ft
- 7-000-15 Masimo Clip Sensor 3.5 ft
- 7-000-13 Nellcor Clip Sensor 3.5 ft
- 7-000-9 Nellcor Ext Cable 7 ft

- 7-400-1 Skin Temp Probe



Criticare Compatible



- 7-473G BP Cuff Infant CSI (13-19 cm)
- 7-474G BP Cuff Sm Adult/Child (19-27 cm)
- 7-475G BP Cuff Adult (23-40 cm)
- 7-476G BP Cuff Lg Adult (34-50 cm)

- 7-934-10DN-G SPO₂ Clip Sensor 10'
- 7-975PD-10G SPO₂ Rubber Sensor Pediatric 10'
- 7-975AD-10G SPO₂ Rubber Sensor Adult 10'
- 7-518DD-G SPO₂ Extension Cable 10'



- 7-204-02 ECG Cable with Lead Wires CSI CAT 1073S

- 7-202-20 Thermal Paper 5/bx



- 7-200-01 Electrode Spray 250 ml
- 7-202-00 Wrist Clamps
(Check Lead Compatibility)



12 OXYGEN / AIRWAY



Oxygen/Airway Set

(Tank Sold Separately)

- Oxygen Regulator 0-15 LPM
- Bag Valve Mask (2)
- Nasal Cannula (2)
- Non-Rebreather O2 Mask (2)
- Nasal Airways (22, 24, 26, 28, 30)
- Oral Airways (60, 70, 80, 90, 100)
- Oxygen Cart

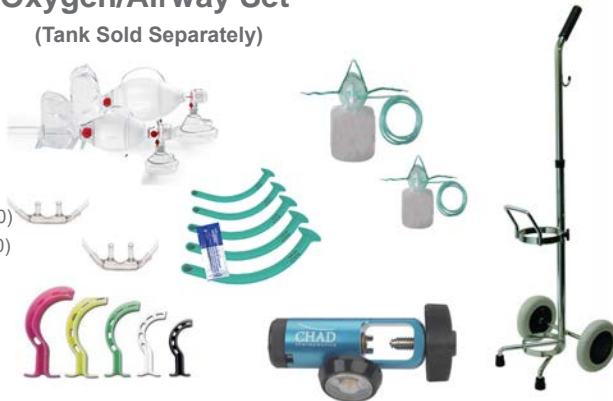

10-000-04
Adult & Child Sizes Included

Bag Valve Mask Resuscitator

Ambu® SPUR® II Disposable Resuscitator

Ergonomic, lightweight design makes extended ventilation less fatiguing while delivering optimal volume

- Includes manometer & medication port
- Unique single-shutter valve system for reliable functionality
- SafeGrip™ surface for secure handling
- Swivel between valve and mask permits 360° positioning of the resuscitator to the patient

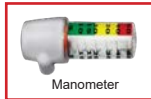

1-003-04 Adult
1-003-05 Child

****Additional Options Available**

Oral Airways

1-101-5 Set (5) 60, 70, 80, 90, 100
Berman Color Coded



1-101-6 Set (5) 60, 70, 80, 90, 100
Guedel Color Coded



Nasal Airways

1-600-5 Set (5) 22, 24, 26, 28, 30
Blue Latex



1-601-5R Set (5) 22, 24, 26, 28, 30
Green Latex-Free



Oxygen Quick Connect Set



- Includes:
- O₂ Quick Connect
 - Dial Flowmeter 25 LPM
 - Diss Hex Nut 1 1/2" Stem 1/8"
 - Oxygen Swivel Adapter (Plastic)

Options:
10-300-00 Porter/Accutron (A1675) (shown above)

10-300-01 Slimline (24199)

10-300-03 Accutron - narrow (27254)

For use to access oxygen through O₂ ports on various nitrous flowmeters and O₂ wall outlets.



See Website Informational Video

Oxygen Quick Connect Only

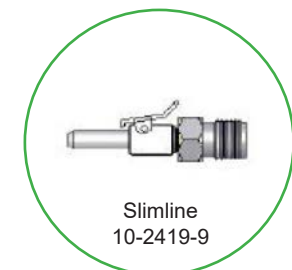

****Chemtron — Ohmeda — Puritan Bennett — Available Upon Request****

Cannula Adapter FOR OXYGEN ONLY!

10-100-1
15 mm Outside Diameter



10-100-3
22 mm Inside Diameter



10-100-4
Bag Tee Cap 22 mm ID



Oxygen E-Cylinder Cart
10-002-01



Oxygen E-Cylinder
Toggle Valve
682 liters
10-002-05
Does not include oxygen

O₂ Regulator
Barb Outlet 0-15 LPM
10-002-03



Oxygen Cylinder Wrench
10-001-04 (Plastic)



Oxygen Swivel Adapter
Fits DISS Port

10-002-08
Plastic



10-002-09
Metal



Nasal Cannula
Adult
10-000-50 50/case
10-000-03 Each
Child
10-001-50 50/case
10-000-00 Each



Non-Rebreather Mask
10-102-02 Adult
10-102-01 Child



Mask & Nebulizer Kit
7' Tubing with Mask
10-102-03 Adult
10-102-04 Child



Cushion Mask with Valve
2-200-02V Size 2 Child
2-200-03V Size 3 Small Adult
2-200-04V Size 4 Adult
2-200-05V Size 5 Large Adult



CPR Board

3-100-00 Size: 24 x 17 x 3

Contoured with recessed handles



16 ADVANCED AIRWAY



Blue Latex - Disposable (SunMed®)

1-600-Sz Sizes: 20, 22, 24, 26, 28, 30, 32, 34, 36



Green Latex Free - Disposable (Rusch® Robertazzi)

1-601-SzR Sizes: 20, 22, 24, 26, 28, 30, 32, 34, 36



Adjustable Airways (SunMed®)

1-604-Sz Sizes: 20, 22, 24, 26, 28, 30, 32 10/pk

- Soft, Movable Flange
- Adjustable Flange
- Latex-Free
- Sterile
- Disposable



Guedel Oral Airways

Color Coded Oral Airway (Each)

- 1-101-60 Size 60 Grey
- 1-101-70 Size 70 White
- 1-101-80 Size 80 Green
- 1-101-90 Size 90 Yellow
- 1-101-99 Size 100 Pink



Berman Oral Airways

Color Coded Oral Airway (Each)

- 1-102-60 Size 60 Grey
- 1-102-70 Size 70 White
- 1-102-80 Size 80 Green
- 1-102-90 Size 90 Yellow
- 1-102-99 Size 100 Pink



Parker Nasal Airway with Flex-Tip

• Slidable depth ring • 15 mm adapter included

1-605-Sz Sizes: 4, 4.5, 5, 5.5, 6 10/bx
6.5, 7, 7.5, 8, 8.5, 9



I-Gel

Supraglottic Airway Device. Non-inflatable Cuff. Easy to use.



- 1-403-15 Size 1.5 5-12 kg, 11-26 lbs
- 1-403-20 Size 2.0 10-25 kg, 22-55 lbs
- 1-403-25 Size 2.5 25-35 kg, 55-77 lbs
- 1-403-03 Size 3 30-60 kg, 66-132 lbs
- 1-403-04 Size 4 50-90 kg, 110-198 lbs
- 1-403-05 Size 5 90+ kg, 198+ lbs



I-Gel Sets (Includes Lubricant)

- 1-403-02 Sizes 1.5, 2, 2.5
- 1-403-01 Sizes 3, 4, 5

I-Gel

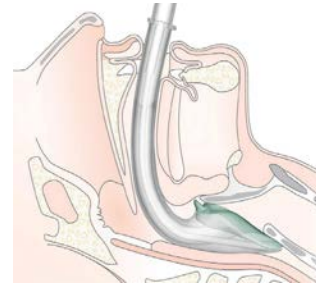

King LTS

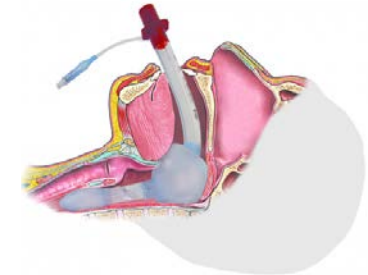

King LTS-D

- 1-402-02S Size 2, <4 feet, Green
- 1-402-03S Size 3, 4-5 feet, Yellow
- 1-402-04S Size 4, 5-6 feet, Red
- 1-402-05S Size 5, > 6 feet, Purple



60 cc Syringe for Cuff Inflation
6-100-60 Each





Sun-Med Parker Flex-Tip® Endotracheal Tube 5/bx

1-205-sz Preformed Nasal Cuffed
 Sizes: 4.0, 4.5, 5.0, 5.5, 6.0, 6.5, 7.0, 7.5 mm

1-206-sz Preformed Nasal Uncuffed
 Sizes: 4.0, 4.5, 5.0, 5.5, 6.0 mm



ET Murphy Uncuffed Oral/Nasal (SunMed®)

1-200-sz Each or 10/bx

Sizes: 3.0, 3.5, 4.0, 4.5, 5.0, 5.5 mm



ET Murphy Cuffed Oral/Nasal (SunMed®)

1-201-sz Each or 10/bx

Sizes: 4.0, 4.5, 5.0, 5.5, 6.0, 6.5, 7.0, 7.5, 8.0 mm



Stylettes

Surgical Stainless Steel
 Reusable Autoclavable



1-202-11 11.5" 6 Fr Each

1-202-16 16" 6 Fr Each

ET Murphy Cuffed Oral/Nasal with Stylette (SunMed®)

1-202-sz Each

Sizes: 4.0, 4.5, 5.0, 5.5, 6.0, 6.5, 7.0, 7.5, 8.0, 8.5 mm



Rusch™ Pre-formed Endotracheal Tube 10/bx

1-203-sz Preformed Cuffed
 Sizes: 4.0, 4.5, 5.0, 5.5, 6.0, 6.5 mm

1-204-sz Preformed Uncuffed
 Sizes: 4.0, 4.5, 5.0, 5.5, 6.0 mm



The Original LMA® Flexible™ Single-Use Airway 10/bx

- Wire-reinforced airway tube provides flexibility and resistance to compression
- Designed to be positioned away from the surgical field without loss of seal
- Ideal for shared airway



*Representative image. Actual product may vary.

1-407-25	Size 2.5	20-30 kg	#115025
1-407-03	Size 3	30-50 kg	#115030
1-407-04	Size 4	50-70 kg	#115040
1-407-05	Size 5	70-100 kg	#115050

LMA® Unique™ (Silicone Cuff) Airway with Cuff Pilot™ Technology Each

1-400-25	Size 2.5	20-30 kg
1-400-03	Size 3	30-50 kg
1-400-04	Size 4	50-70 kg
1-400-05	Size 5	70-100 kg



Fiber Optic Stainless Steel Greenline Compatible

F/O Laryngoscope Set with Disposable Blades

Set Includes:

Carrying Case, Medium Handle, and Blades

Macintosh Blade sizes: 2, 3, 4

Miller Blade sizes: 0, 1, 2, 3

Batteries not included

2-202-00



Rusch® DispoLED® Single-Use Fiber Optic Laryngoscope Handle with Rusch® Polaris™ Single-Use Fiber Optic Macintosh 3 Laryngoscope Blade

2-1501-03

Rusch® DispoLED® Laryngoscope Handle is a single-use, fiber optic laryngoscope handle.

- Includes LED lamp and batteries



Rusch® Polaris™ Single-Use Fiber Optic Macintosh 3 Laryngoscope Blade

- Designed to withstand the forces of intubation with the weight and feel of a reusable blade
- Low-profile blade design with matte finish to help reduce light reflection
- 4.7 mm enclosed fiber optic cable for greater light transmission (in adult sizes)

Medium Fiber Optic Handle S-Steel Waterproof

2-0236-39

Requires C Batteries x 2 (not included)

F/O Miller Blade

2-5273-02	Child	152 mm	14 mm
2-5273-03	Med Adult	192 mm	15 mm
2-5273-04	Large Adult	207 mm	16 mm



F/O Macintosh Blade

2-5272-02	Child	100 mm	21 mm
2-5272-03	Med Adult	135 mm	20 mm
2-5272-04	Large Adult	155 mm	20 mm



F/O Laryngoscope Lamp

2.5 Volt
2-0240-52



Intubation Kits

- 8 Oropharyngeal Color Coded Guedel Airway (sizes 00-6) (40 mm-100 mm)
- 1 Pediatric Chrome Plated Laryngoscope Handle
- 1 Medium Chrome Plated Laryngoscope Handle
- 5 Miller Laryngoscope Blades (sizes 0-4)
- 4 Macintosh Laryngoscope Blades (sizes 1-4)
- 4 Extra Laryngoscope Lamps (Conventional)
- 1 Extra Handle Lamp (Fiber Optic)
- 1 Adult Magill Forceps
- 1 Pediatric Magill Forceps
- 2 C Batteries
- 2 AA Batteries
- 4 Packets of Lubricating Jelly
- 2 Endotracheal Uncuffed Tubes (sizes 2.5, 4 mm)
- 8 Endotracheal Cuffed Tubes (sizes 5-10 mm)
- 1 Nasopharyngeal Airways (20, 24, 28, 32 FR)
- 1 10 ml Syringe
- 1 Endotracheal Tube Introducer
- 1 Adult Stylette
- 1 Nylon Airway Management Case



Conventional Intubation Kit

Includes List Above (Conventional Blades) 1-100-00

Fiber Optic Intubation Kit

Includes List Above (Fiber Optic Blades) 1-100-02



Intubation Set

1-201-5

5 ET Tubes Cuffed (5.0, 5.5, 6.0, 6.5, 7.0 mm)

Stylette, Lubricant, and 10 cc Syringe

Rusch® Quicktrach®

- Pre-assembled QuickTrach®
- Introducer 12 Fr
- 10 cc Syringe
- Padded neck strap
- Connecting tube

1-300-20 Pediatric 2.0 mm
1-300-40 Adult 4.0 mm



Field Cricothyrotomy Kit

- Scalpel, 3"
- ET tube Holder with Velcro Strap
- Curaplex® Trach Hook
- Syringe, Luer Lok, 10 cc
- Mask, with Earloop and Plastic Shield
- Pack of Gauze, 4" x 4", PVP Prep Pad
- Curaplex® ET Tube, Cuffed, 5.5 mm w/o Stylette

1-300-41



In-line Metered Dose Inhaler Adapter (MDI) Albuterol Adapter

1-400-01

Compatible with Dose Counter or Standard MDI Canisters



CO₂ Sampling Adapter

7-660-5

In-line T-Connector 15 mm / 22 mm



Racine Universal ET Tube Adapter

1-202-71



CONFIDENT MONITORING



The Sedation Stethoscope® is an essential tool for sedation practitioners. It provides a window to the airway—delivering clear, amplified breath sounds—for continuous, real-time monitoring. Providers have the ability to detect airway changes early to respond quickly. Its Bluetooth® connectivity enables mobility while maintaining seamless monitoring at all times, keeping your focus on patient safety and care. Enhance your sedation procedures with the Sedation Stethoscope®!

Hands-Free, Wireless Mobility

Experience freedom of movement with Bluetooth® connectivity and up to 18 hours of continuous operation.



Enhanced Airway Monitoring

Hear amplified sounds in real-time to identify changes and respond appropriately to maintain patient safety.



21-100-01S

Includes rechargeable amplifier, Bluetooth® headset, Piezo chest piece cable, backup earbuds, rechargeable batteries, 20 double-sided adhesive discs, USB charger, and A/C charger.

1 year warranty



Double-Sided Adhesive Discs

100 per pack
11-200-11





Rechargeable Batteries 4/pack

1000mAh Ni-MH
21-AAAR



Replacement Parts

1 Year Warranty

		
Replacement Headset 11-HS1	Piezo Amplifier-Power Switch* 21-100-02S	Piezo Chestpiece Cable* 21-100-03

***Must Confirm Compatibility**

Piezo Chest Piece

A weighted chest piece with a built-in microphone produces diagnostic quality sound and reduces ambient noise.



The Piezo Chest Piece can be placed at the pretracheal notch with a double-sided adhesive disc.

Pretracheal Pickup Cable

The Pickup Cable is pre-attached to the Chest Piece and is plugged into the Chest Piece port on the amplifier.



Avoid pulling cable away from chest piece during cleaning. Instead, clean cable moving cleaning cloth toward the chest piece. Like other electronic cables, it is best to loosely coil the pretracheal pickup cable for storage.

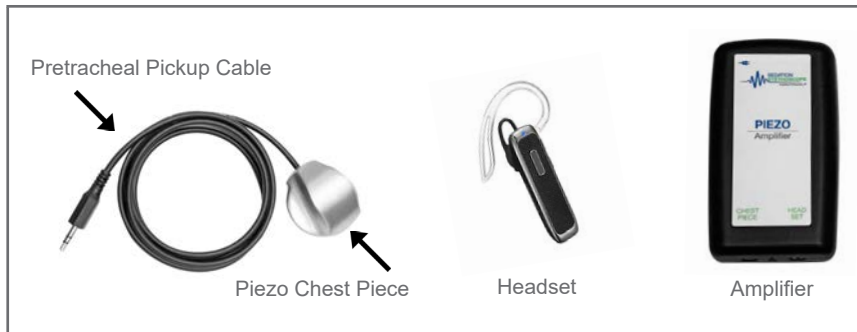

Bluetooth Headset

The included Bluetooth headset provides 18 hours of continuous use, high quality sound, and has a range of approximately 33 ft/10 m.



It is only necessary to charge the headset until the indicator light is off. Overcharging can deplete its useful life.

Amplifier

The compact amplifier is easy to use, provides outstanding amplified sound, and has integrated Bluetooth technology. A built-in charging port makes recharging the 1000mAh Ni-MH batteries a breeze. For best performance, replace batteries every 6-9 months (item 21-AAAR).



The amplifier is fully charged when the green light goes off or in approximately 1 1/2 to 2 hours. Charging the unit overnight is not recommended.



Need assistance with your Sedation Stethoscope?
Reach out to our dedicated Technical Support Team.

903.634.5333 Option: 3

SedationStethoscope.com

800-753-6376

SEDATIONRESOURCE.com

28

IV ADMINISTRATION



EXTENSION SETS

Extension Sets Male and Female Luer Lock

60" 2.0 ml
6-202-08 100/bx
6-202-08C (Vygon) 50/bx

60" 1.2 ml
6-205-60 100/bx
6-205-60C (Vygon) 100/bx

7" .32 ml
6-205-07 50/bx

7" .50 ml With Standard Injection Site
6-202-12 50/bx



Standard IV Administration Sets

Exel, (1) Injection Site, 78", Luer Slip, 15 drops/ml
6-201-04 50/bx

Exel, (1) Injection Site, 78", Luer Lock, 15 drops/ml
6-201-05 50/bx

Exel, (1) Injection Site, 78", Luer Slip, 60 drops/ml
6-201-06 50/bx

Exel, (1) Injection Site, 78", Option Lock, 15 drops/ml
6-201-07 50/bx

ACC, (1) Injection Site, 92", Rotating Male Luer Lock, 20 drops/ml
6-202-10 50/bx

Vygon, (2) Injection sites, 105", Luer Lock, 20 drops/ml
6-202-02 50/bx



Safety IV Administration Sets

ACC, (2) Needleless Ports, 97", Rotating Male Luer Lock
10 drops/ml

6-202-04 50/bx

ACC, (1) Needleless Port, 102", Rotating Male Luer Lock
10 drops/ml

6-202-06 50/bx



Medex Stopcocks

3-Way Standard bore Stopcock w/ swivel Male Luer Lock

6-205-04 50/bx



IV EQUIPMENT

IV Stand

4-Leg 2-Hook

6-900-0



Elbow Immobilizer

6-700-01 11" Adult

6-700-02 8" Child



Wrist Immobilizer

6-700-03



AccuVein® Vein Visualization System

Laser Precision for Reliable Access

- AV500 uses advanced laser technology for clearer, more accurate vein visualization, even in darker skin tones and with various body types

Permanent Alignment

- Utilizes True Center™ Technology to keep it permanently aligned, without need for recalibration

Portable, Lightweight, Easy to Use

- Has 3 brightness settings and inverse color setting
- Includes Desktop Charging Cradle for continuous charging
- Stand and adjustable arm are available for purchase



6-AV500

Improve the patient experience and avoid delays
or cancellations in sedation cases due to
venous access challenges!

NEEDLES & SYRINGES

Exel Syringe with Needle 100/box

6-403-21	3 cc	21 G x 1
6-403-22	3 cc	22 G x 1 1/2
6-405-20	5 cc	20 G x 1
6-405-21	5 cc	21 G x 1 1/2
6-405-22	5 cc	22 G x 1 1/2
6-410-21	10 cc	21 G x 1 1/2
6-410-22	10 cc	22 G x 1



BD Syringe with Needle 100/box

6-301-01	1 cc	25 G x 5/8
6-300-08	3 cc	23 G x 1
6-300-04	3 cc	25 G x 1



Medline Regular Bevel Needle 100/box

6-102-18	18 G x 1
6-102-20	20 G x 1
6-102-22	22 G x 1



BD Regular Bevel Needle 100/box

6-100-23	23 G x 1
6-100-25	25 G x 1



Syringe Only Syringe Only Luer Lock

6-200-01	Exel	1 cc	100/bx
6-200-03	BD	3 cc	200/bx
6-200-05	BD	5 cc	125/bx
6-200-10	BD	10 cc	200/bx
6-200-20	BD	20 cc	48/bx
6-200-60		60 cc	25/bx







IV CATHETERS

Safelet IV Catheter

6-303-21	Safelet 20 G x 1	
6-303-22	Safelet 22 G x 1	
6-303-24	Safelet 24 G x 3/4	





Surflo IV Catheter

6-304-20	Surflo® 20 G x 1 1/4	
6-304-21	Surflo® 20 G x 1	
6-304-22	Surflo® 22 G x 1	
6-304-24	Surflo® 24 G x 3/4	





BD Insyte AutoGuard Shielded IV Catheter

6-301-20	BD Insyte 20 G x 1	
6-301-22	BD Insyte 22 G x 1	
6-301-24	BD Insyte 24 G x 3/4	



BBraun Introcath Safety IV Catheter

6-305-20	BBraun 20 G x 1	
6-305-22	BBraun 22 G x 1	
6-305-24	BBraun 24 G x 3/4	



Mucosal Administration Device

Nasal Atomizer with 3 cc Syringe
6-199-00 Each

Nasal Atomizer Tip Only
6-199-01 25/bx



Seraket® Adjustable Tourniquet

Fits all size limbs
6-100-04



Latex Free Tourniquets 100/pkg

6-100-00



Tegaderm Dressing Transparent 100/box

6-108-01
2 3/8" x 2 3/4"



3M™ Tape 1" Wide 12/box

6-109-05 Transpore Plastic
6-109-06 Micropore Paper
6-109-07 Durapore Silk



Alcohol Prep Pads 200/box

6-100-02

Curity Fabric Bandages 50/box

3/4" x 3"
6-103-07



IV Access Set

- 22 G x 1 Catheter
- 24 G x 3/4 Catheter
- 1 4" IV Extension Set
- 1 Tegaderm Tape
- 1 Transpore Tape
- 1 Chloraprep
- 1 Pair of Gloves
- 1 Tourniquet
- 1 Alcohol Prep
- 2 Gauze Pads
- 1 Pre-filled 10 cc Saline Syringe



6-000-02

34

MISCELLANEOUS



Anesthesia Drug Syringe Label Tape
330/roll



AN-106 Alfentanil	AN-11 Lidocaine
AN-35 Antibiotic	AN-12 Meperidine
AN-202 Ativan	AN-120 Midazolam
AN-1 Atropine	AN-13 Morphine
AN-41 Brevital	ANS-14 Naloxone
AN-203 Decadron	AN-15 Nesostigmine
AN-46 Demerol	AN-28 Nubain
AN-132 Dexamethasone	AN-55 Ondansetron
AN-3 Diazepam (Vallium)	AN-81 Phenylephrine
AN-210 Diphenhydramine	AN-24 Precedex
AN-155 Diprivan (Propofol)	AN-27 Propofol
AN-14 Drug Blank	AN-65 Reglan
AN-5 Ephedrine	AN-38 Remifentanyl
AN-6 Epinephrine	AN-161 Rocuronium
AN-7 Fentanyl	AN-20 Succinylcholine
ANS-18 Flumazenil	AN-201 Toradol (Ketoralac)
AN-9 Glycopyrrolate	AN-149 Versed
AN-16 Hydromorphone	AN-105 Xylocaine
AN-60 Ketamine	AN-58 Zofran

Dispenser: Multi-Roll

Holds multiple rolls of tape and labels with 1" cores 3-3/8" x 9-7/8" x 4-1/2"

AN-500-P



Magill Forceps

Surgical Stainless Steel

- 1-202-02 Adult 10"
- 1-202-01 Child 8"

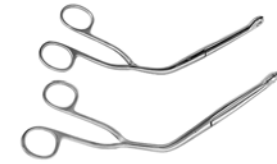

Tongue Seizing Forceps

Surgical Stainless Steel with Latex Rubber Tips

1-202-03



Megazinc Pink Tape

Latex-free, zinc oxide based, waterproof adhesive tape
Great for ET Tube placement 1/2" x 5 yds

6-109-04



Sterile Surgical Lubricant

4 oz Tube
1-106-00

2.7 g Packets 144/box
1-106-01



DEA-Compliant Drug Cabinet

- 14.5 H x 9.5 W x 4 D
- Double-locking
- Each door has individual key
- Removable and adjustable shelf

16-200-0



Wheelchair 19"

Chrome Frame
Lightweight - Less than 26 lbs
Weight Capacity 300 lbs

16-000-19



Rainbow Airway Positioners

Molded Foam
SP-AP-FM

Soft Foam, Teal Vinyl
SP-AP VINDt



Stay N Place® Head Cradle

Nylon Cover
SPHC-C Child
SPHC-U Adult

See website for sizing details



Stay N Place® Neck Pillow

SPNP-P Child
SPNP-A Adult



38 ANESTHESIA



Portex Breathing Circuits

2-301-00 Expandable 40-100"
Breathing Filter
Pedo Bag 1.0 L 20/bx

2-302-01 Expandable 33-87"
NO FILTER
Adult Bag 3L 20/bx



Breathing Filter

2-100-01 40/case



Heat & Moisture Exchanger

2-400-00 40/case



Rusch™ Anesthesia Mask with Color Coded Rings

2-200-02R	Size 2	Child	Yellow	20/bx
2-200-03R	Size 3	Small Adult	Green	20/bx
2-200-04R	Size 4	Adult	Red	20/bx
2-200-05R	Size 5	Large Adult	Blue	20/bx



40 NITROUS OXIDE





Double-Mask Autoclavable Hood Kit

- 4-5054-A Adult Hood Kit w/ 3 Liners
- 4-5054-B Pedo Hood Kit w/ 3 Liners

Autoclavable Liners

- 4-5054-1 Adult Liner Kit - Pkg of 3
- 4-5054-2 Pedo Liner Kit - Pkg of 3

Disposable Liners

- 4-5053-AD Adult Disposable Liners 12/pk
- 4-5053-PD Pedo Disposable Liners 12/pk



Hoods with Tubing 12/pack

- 4-000-02 Pediatric
- 4-000-03 Small Adult
- 4-000-04 Medium
- 4-000-05 Large
- 4-000-01 Variety Pack - 4 Sizes



Luer lock Barbs

- 4-000-09 25/pk



- 4-000-00 Flowmeter Connection Kit
 - Cannula Adapter
 - Breathing Bag Cap
 - 6.5' Fresh Gas/Vacuum Tubing
 - 4 Color coded Sizer Mks

Matrix Autoclavable Hood

- 4-5094 Pedo
- 4-5095 Medium
- 4-5096 Adult



- 4-6461 Single-Use Hoods Small Bubble Gum 24/pk

- 4-5142 Nasal Hood Adapter Kit



*Includes Adapter

ClearView™ with CO₂ Adapter Single Use (12/pack)



- 4-3509-CAP Adult Unscented
- 4-3514-CAP Adult French Vanilla
- 4-3709-CAP Pedo Unscented
- 4-3712-CAP Pedo Bubble Gum
- 4-3409-CAP Large Adult Unscented



Capnography Adapter Only

- Double Lumen 12/pk
- 4-43055

Axess™ Low Profile Hood Single-Use 24/pack

- 4-3037-9 Small Unscented
- 4-3037-16 Small Mint
- 4-3035-9 Medium Unscented
- 4-3035-16 Medium Mint
- 4-3035-12 Medium Bubble Gum



Capnography Adapter Only

- Single Lumen 24/pk
- 4-53055

DENTAL

Simulation Specialists



Hands-on scenario management training with emergency simulations in a dental office



Simulate a real life emergency without a patient

We are proud to be endorsed by the American Association of Oral and Maxillofacial Surgeons (AAOMS) to offer an AAOMS Office-Based Emergency Airway Management (OBEAM) Equivalency Course.



Experience the gold standard of in-situ simulation for yourself, your assistants, and your staff. Evaluate and refine your team's readiness to handle an office emergency.



Scan to learn more



See page 52 for information on the Simulation Toolkit™

44

SUCTION & BACK-UP



SUCTION

Drive Portable Suction AC/DC

12-600-03

- Weight: 6.3 lbs Size: 9" x 7" x 8"
- Battery operated or AC
- Vacuum 80 to 550 mmHg
- 800 cc Collection bottle with tubing
- Internal battery & recharging system
- Up to 45 minutes operation with full battery charge



Disposable Suction Canister Kit 800 cc

12-600-04

Replacement canister and tubing

Laerdal Compact Suction AC/DC

12-700-00

- Weight: 3.3 lbs Size: 7" x 10" x 3"
- Battery operated or AC
- Vacuum 50 to 550 mmHg
- 300 cc Collection bottle with tubing
- Internal battery & recharging system
- Up to 45 minutes operation with full charge



Yankauer Disposable Suction

- 12-401-00 Yankauer Only
- 12-401-03 Yankauer with HVE Adapter



Suction Tubing

12-401-06 72" Blue Tip Suction Tubing



Nasogastric Suction Tubing

- 12-500-04 8 Fr
- 12-500-05 10 Fr
- 12-500-06 16 Fr
- 12-500-07 14 Fr
- 12-500-03 18 Fr



DIAGNOSTIC BACK-UP

NONIN Onyx® Vantage Finger Pulse Oximeter

Scientifically proven accuracy in the widest range of patients - including challenging cases due to low perfusion and darker skin tones.

- 4-Year Warranty
 - 2 AAA Batteries
- 5-300-14



No-Contact Infrared Digital Thermometer

Includes 2 AAA Batteries
5-200-07



Stethoscope Sprague Rappaport

5-300-0



Aneroid Sphygmomanometer

- 5-100-01 Child
- 5-100-02 Adult
- 5-100-03 Adult Lg



Backup Precordial Stethoscope Kit

Includes 2 Wenger chest pieces, reusable earbud with tubing, disposable monoscope, 50 adhesive discs.

11-400-00

Wenger Chestpiece

- 11-200-03 Child
- 11-200-04 Adult

Soft Ear Disposable Monoscopes

11-401-25 25/pkg



ZOLL

Empowering you to help save lives®

ZOLL AED 3

The **ZOLL AED 3**® defibrillator is equipped with Real CPR Help® to aid rescuers in performing high-quality CPR, with feedback and guidance regarding compression depth and rate. It utilizes the Uni-padz®, a universal pad designed to treat both adult and pediatric patients. It features a large, color touchscreen and is powered by a 5-year smart battery. The AED 3® has an impressive 8-year warranty, with registration.



ZOLL AED PLUS

The **ZOLL AED Plus**® defibrillator also utilizes Real CPR Help® technology, empowering rescuers to deliver high-quality CPR with visual and audio prompts. It connects to CPR-D-Padz® and Pedi-Padz II® electrodes. Its Passive Airway Support System, durable design, and long-lasting lithium batteries make it ideal for multiple environments. The AED Plus has a 7-year warranty, with registration.



ORDERTODAY!
SEDATIONRESOURCE.COM

48 EMERGENCY





ZOLL AED Plus®
15-100-00



- ECG Waveform
- One-piece CPR-D-Padz® with 5-Year Shelf Life*
- Real CPR Help®-feedback during CPR
- Intelligent Pediatric Capabilities
- Trainer Available
- Consumer Batteries
- 7-Year Warranty (with registration)



ZOLL AED Plus® Accessories

- 15-100-01 CPR-D-Padz®
- 15-100-02 Pedi-Padz® II (2-year shelf life)
- 15-100-03 Set of Batteries

ZOLL AED 3®
15-103-00

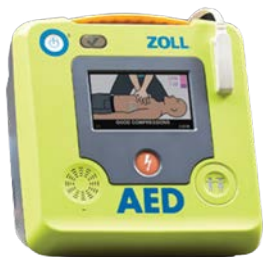

- ECG Waveform
- CPR Uni-padz®-universal pad to treat both adult and pediatric patients with 5-Year Shelf Life*
- Real CPR Help®-feedback during CPR
- RapidShock™ Analysis-rhythm analysis
- 5-Year Smart Battery
- 8-Year Warranty (with registration)



ZOLL AED 3® Accessories

- 15-103-02 CPR Uni-padz®
- 15-103-03 Battery Pack

HeartSine 350P
15-500-00

- Semi-Automatic
- Trainer Available
- Electrode Pad Life 4 Years*
- Battery and Pad Combination
- 8-Year Warranty



HeartSine AED Accessories

- 15-500-01 Adult Pad/Battery Pak
- 15-500-02 Pedi Pad/Battery Pak

Philips Onsite HeartStart AED Accessories

- 15-300-01 Adult Pads
- 15-300-02 Pedi Pads
- 15-300-03 Battery



Cardiac Science G3 AED Accessories ONLY

- 15-000-01 Adult Pads
- 15-000-02 Pedi Pads
- 15-000-03 Battery

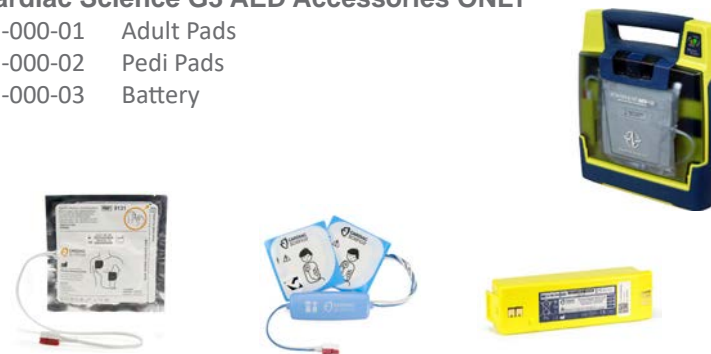

The Cardiac Science AED has been Discontinued
Accessories available while supplies last

NIO® Intraosseous Kits

When you need immediate vascular access, you can be confident that the NIO is complete and ready to use. The NIO is an automatic intraosseous access device packaged for quick, safe, and easy vascular access. No drills. No batteries. No assembly.

Kit Includes:

- NIO Intraosseous Device
- GO Start Kit (alcohol pads, extension set, 3-way stopcock, IV strap, patient bracelet)
- Chloraprep
- IV flush

6-601-15 NIO Adult® Kit 15G Needle

6-601-18 NIO Pediatric® Kit 18G Needle



ARROW® EZ-IO® Set (available to dental professionals only)

The EZ-IO® enables safe, simple, and speedy access to the patient's circulatory system when IV access is difficult or impossible. The EZ-IO® can be used to establish stable and secure vascular access in less than 10 seconds - for both alert and unconscious children and adults.

Set Includes:

- G-3 Driver
- Two EZ-IO® Needles (adult & pediatric sizes available)
- Soft Carrying Case

6-601-00 Two Adult Needles (15 gauge sterile 25 mm EZ-IO® Needle)

6-601-13 One Adult and One Pediatric Needle (15 gauge sterile 25 mm EZ-IO® Needle and 15 gauge sterile 15 mm EZ-IO® Needle)



Arrow® EZ-IO® Needle + Stabilizer Replacement Kit includes:

- An adult or pediatric EZ-IO® needle (based on order)
- EZ-Stabilizer® Dressing
- EZ-Connect® Extension Set
- NeedleVISE® Sharps Block
- Pink patient wristband
- Kit has a 4-year shelf life and is not made with natural rubber latex

6-9001P Adult

6-9018P Pediatric



Simulation Toolkit™

Empower your team. Order your Simulation Toolkit™ today!



Includes:

- AED trainer
- Bag Valve Mask resuscitator
- Laryngoscope with Macintosh 3 blade
- Airway adjuncts (I-gel [size 3], Berman oral airways [80 and 90 mm], nasal airway [28 Fr])
- Lubricant packets
- Magill forceps
- Yankauer suction catheter with HVE adapter
- MAD Nasal™ Intranasal Mucosal Atomization Device
- Syringes and needles
- Mock medications - epinephrine auto-injector trainer, inhaler trainer, mock aspirin and nitroglycerin, mock atropine syringe, and various mock medication vials
- Soft bag with handles

8-200-01

“Airway Larry” Manikin Head and Mounting Kit - Complete Set

- Includes “Airway Larry” manikin head, mounting board, lungs, stomach, and hard carrying case
- Readily simulates the triple airway maneuver
- Allows endotracheal intubation, placement of oral and nasal airways, and positive pressure ventilation with a full face mask



8-100-04

Airway Intubation Training Manikin

- Budget-priced manikin intended to assess correct placement of extraglottic devices and oral intubation
- Simulates triple airway maneuver
- Will accept full face mask and small oral and nasal airways
- Includes carrying case



8-100-02

WHAT'S NEW

We are diligent at seeking out products to meet YOUR needs!



AccuVein® Vein Visualization System

See **PAGE 30** to learn more about how the AV500 can change your practice. Increase patient comfort and satisfaction and decrease provider frustration when accessing veins!



Innovation Meets Care

iX Series **NEW**

- Efficient user interface
- Gesture operations
- Capacitive touch buttons
- Auto brightness adjustment with anti-glare design
- 15-second NIBP readings with iFAST technology



SEDATION RESOURCE, INC. POLICIES & CONDITIONS

800.753.6376 — 903.634.5333 Opt. 2
Fax 903.662.4305
info@sedationresource.com

Ordering

Our Customer Service Team is available weekdays 8 am - 4 pm CST.
Place orders by phone, fax, email, or online.

Shipping

Order online 24/7!
SedationResource.com

- Orders are typically processed and shipped within 1 business day.
- Shipping charges are based on method of shipment, weight, and destination.
- Special shipping services are available upon request (*additional charges will apply*).
- We do not ship orders COD.
- International order expenses (*such as insurance, duties, and shipping*) are the responsibility of the customer.
- Urgent orders must be submitted by 10:30 am CST.

Return Request

Submit your return request from the **Contact Us** link on our website or give us a call for a Returns Materials Authorization (RMA).

- All returns are subject to approval.
- Products must be returned unused, in their original packaging, and in sale-able condition.
- Any returns after 30 days from invoice date are subject to a 20% restocking fee.
- Sterile products cannot be returned.
- Special order items and/or items that are noted "non-returnable" may not be returned.
- All refunds are subject to a 5% processing fee, except in cases of defective items or fulfillment issues.

Damages:
Claims for missing or damaged items must be reported within 48 hours. Upon receipt of shipment, inspect cartons for any visible damage. If any parcel is visibly damaged, do not accept it. If damage is noticed subsequently, notify the carrier immediately.

Shortages:
Check your packing slip to ensure the item(s) have not been backordered. When reporting, please have the packing slip and original packing materials available.



PO Box 250
Lone Oak, TX 75453

YOUR PARTNER IN PATIENT SAFETY



800.753.6376 | SEDATIONRESOURCE.COM